

## Glass door hinge

Web code  
DQDP5A

## Planning

Hinge dimensions and gap calculation based on factory setting (mounting plate spacing = 0 mm)

Hinge and front protrusion at full opening angle

## Overlay application

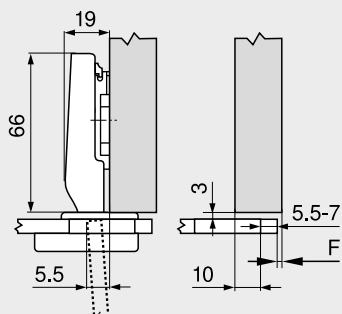
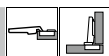

F Gap

## Dual application

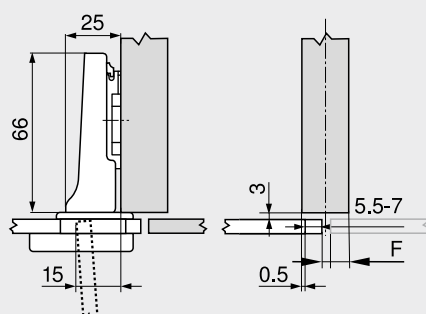
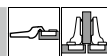

F Gap

## Inset application

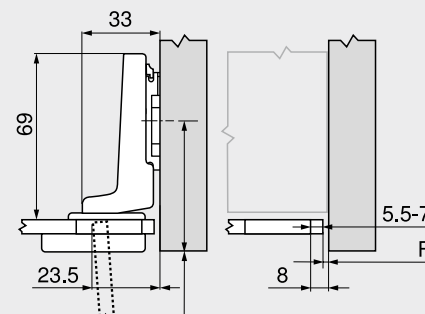
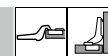
F Gap  
Move back fixing position of mounting plate by front thickness  
FD and height of boss cover +3 mm

## Drilling distance TB

Front overlay FA (mm)												
MD	7	8	9	10	11	12	13	14	15	16	17	
0										6	7	
3								6	7			
6				6	7							
9	6	7										
MD Mounting plate spacing (mm)												

Front overlay FA (mm)												
MD	-2.5	-1.5	-0.5	0.5	1.5	2.5	3.5	4.5	5.5	6.5	7.5	
0										6	7	
3							6	7				
6				6	7							
9	6	7										
MD Mounting plate spacing (mm)												

Front overlay FA (mm)												
MD	-5.5	-5	-4.5	-4	-3.5	-3	-2.5	-2	-1.5	-1		
0												
3	5.5	6	6.5	7								
6												
9												
MD Mounting plate spacing (mm)												

## Minimum gap F for fronts with a front radius (R = 1 mm) based on the factory setting

For front thicknesses FD from 4.5 to 7 mm, no gap F is required

## Adjustment

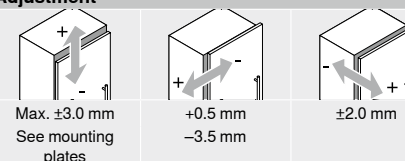

## Screw-on

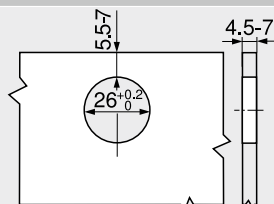

## Hinge boss dimensions

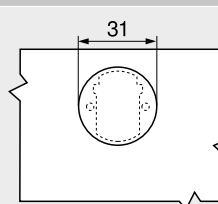

## Hinge boss cover cap

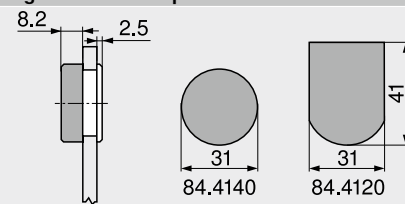

## Reference pages

Overview – CLIP top BLUMOTION   CLIP top – hinges	71
Mounting plates	144
Accessories – hinge arm cover cap	151
Accessories – general	153
Overview – BLUMOTION for doors	157
Overview – TIP-ON for doors	171
Overview – assembly devices	591
More technical details	698

## Assembly, removal and adjustment

Short URL  
[www.blum.com/a210](http://www.blum.com/a210)